



Muruj Smouha



ABOUT THIS PROJECT:

Market Segment:
General Construction

Contractor:
Al-Batony Engineering
& Contracting

Products Used:
Xypex Concentrate

Location:
Alexandria, Egypt

Engineers:
Armed Forces Engineering Authority of Egypt

DESCRIPTION

Under the supervision of the Armed Forces Engineering Authority of Egypt, Beton Company and Al-Batony Engineering & Contracting used Xypex Concentrate to permanently protect and water-proof the base slab for the Muruj Compound located in Alexandria, Egypt.

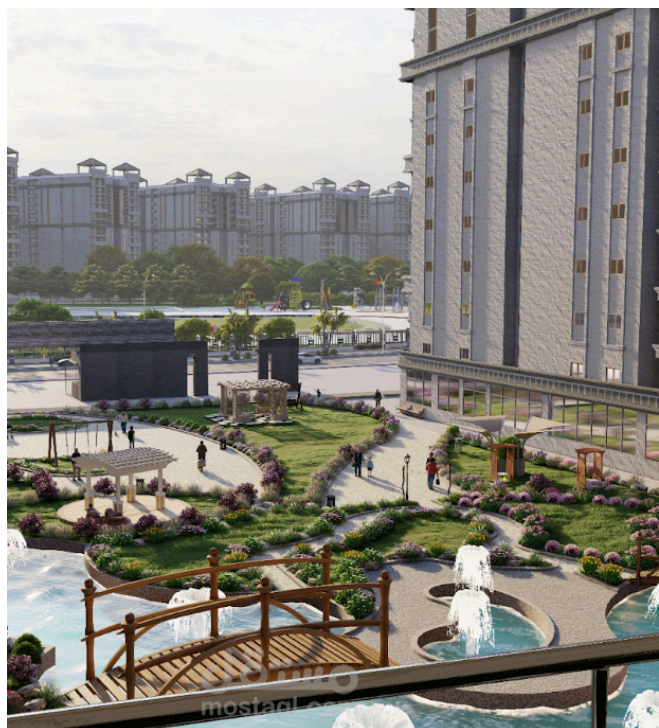

Muruj Compound located in Alexandria, Egypt.

THE XYPEX SOLUTION

Xypex Concentrate consists of Portland cement, finely graded sand and active proprietary chemicals. It is applied as a cementitious slurry to the pre-saturated surface of existing above and below-grade structures.

The active chemicals diffuse into the substrate and react with moisture to cause a catalytic reaction. This reaction generates a non-soluble crystalline formation throughout the pores and capillary tracts of the concrete, as well as cracks, permanently sealing the concrete and preventing the penetration of water and other liquids from any direction, even under high hydrostatic pressure.

To learn more about how Xypex protects foundations in general construction, please [click here](#).